



Electrolux
PROFESSIONAL

**Modular Cooking Range Line
thermaline 90 - 1000 mm Electric
Warming Cabinet with 2 doors, GN
conform, 1 Side (H2) - H=550**

ITEM # _____

MODEL # _____

NAME # _____

SIS # _____

AIA # _____

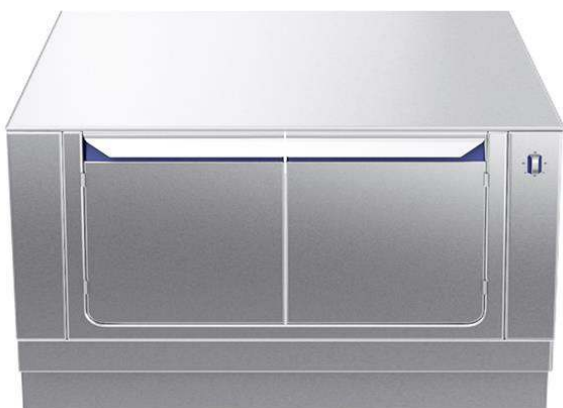

589490 (MC4HDAJOAO)

Electric warming cabinet,
with 2 doors, one-side
operated, GN - H2

Short Form Specification

Item No. _____

1000 mm wide warming cabinet with 2 doors, constructed according to DIN 18860_2 with 70 mm recessed plinth. Internal frame for heavy duty sturdiness in 2 mm and 3 mm in 1.4301 (AISI 304). 2 mm top in 1.4301 (AISI 304). Flat surface construction, easily cl

Main Features

- All major components may be easily accessed from the front.
- THERMODUL connection system creates a seamless work top when units are connected to each other thus avoiding soil penetrating vital components and facilitating the removal of units in case of replacement or service.
- Unit constructed according to DIN 18860_2 with 70 mm recessed plinth.
- Temperature in the cupboard can be set through a thermostat to suit different requirements. The maximum temperature is 110°C.
- [NOT TRANSLATED]

Construction

- IPX5 water resistance certification.
- 2 mm top in 1.4301 (AISI 304).
- Flat surface construction with minimal hidden areas to easily clean all surfaces
- Storage space in the base of the appliance accepts GN1/1 containers.
- Internal frame for heavy duty sturdiness in stainless steel.

APPROVAL: _____



Experience the Excellence
www.electroluxprofessional.com

Front

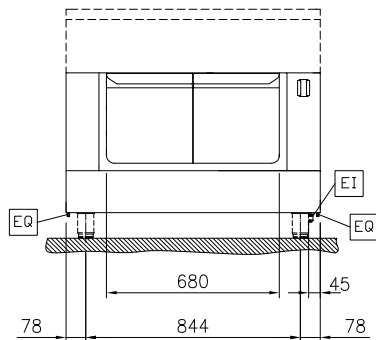

Side

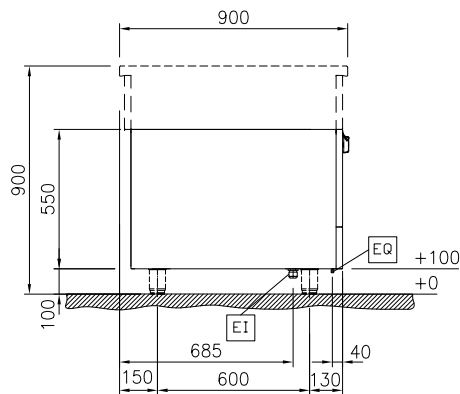

EI = Electrical inlet (power)

Top

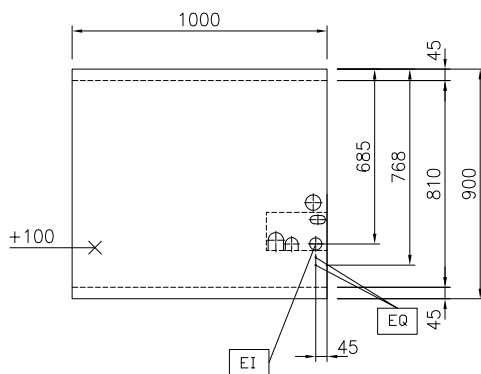

Key Information:

External dimensions, Width:	
589490 (MC4HDAJOAO)	1000 mm
External dimensions, Depth:	900 mm
External dimensions, Height:	550 mm
Cupboard Cavity Dimensions (width):	680 mm
Cupboard Cavity Dimensions (height):	330 mm
Cupboard Cavity Dimensions (depth):	715 mm
Cabinet temperature range:	30-110 °C
Net weight:	34 kg

Sustainability

Current consumption:	5 Amps
----------------------	--------

Optional Accessories

- Stainless steel side panel (12mm), PNC 912511 ☐
900x800mm, freestanding
- Stainless steel front kicking strip, PNC 912600 ☐
1000mm width
- Stainless steel side kicking strips PNC 912621 ☐
left and right, freestanding,
900mm width
- Stainless steel side kicking strips PNC 912624 ☐
left and right, wall mounted,
900mm width
- Stainless steel side kicking strips PNC 912627 ☐
left and right, back-to-back,
1800mm width
- Stainless steel plinth, against PNC 912903 ☐
wall, 1000mm width
- Stainless steel plinth, PNC 912922 ☐
freestanding, 1000mm width
- Stainless steel panel (12mm) PNC 913102 ☐
900x800mm, against wall, left
side
- Stainless steel panel (12mm) PNC 913106 ☐
900x800mm, against wall, right
side
- Back panel, 1000x550mm, for PNC 913184 ☐
bases and units, one-side
operated
- Stainless steel side panel, left, PNC 913224 ☐
H=800, flush
- Stainless steel side panel, left, PNC 913225 ☐
H=800, flush
- - NOT TRANSLATED - PNC 913235 ☐
- - NOT TRANSLATED - PNC 913244 ☐
- - NOT TRANSLATED - PNC 913259 ☐
- - NOT TRANSLATED - PNC 913268 ☐
- - NOT TRANSLATED - PNC 913270 ☐
- - NOT TRANSLATED - PNC 913277 ☐
- - NOT TRANSLATED - PNC 913278 ☐
- - NOT TRANSLATED - PNC 913283 ☐
- - NOT TRANSLATED - PNC 913673 ☐
- - NOT TRANSLATED - PNC 913676 ☐
- - NOT TRANSLATED - PNC 913689 ☐